

Origen^æ

S21^T user guide

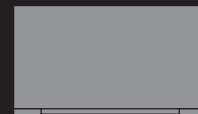
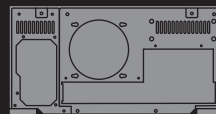

S21T

user guide

Thank you for purchasing this Origen^{ae} htpc enclosure. We recommend that you read this user guide thoroughly before installation.

Origen^{ae} is not responsible for any damages due to external causes, including but not limited to, improper use, problems with electrical power, accident, neglect, alteration, repair, improper installation or improper testing.

Revision S21T.V2/02.08

Copyright © 2012 Origen^{ae} Technology.
All rights reserved



index

S21T specifications	4
S21T overview	5
Opening the case	7
Removing motherboard tray	7
Micro ATX standoff installation	8
VGA bracket/loop cable	8
Optical disk drive installation	9
Optical drive bezel installation	10
Metal sticker fitting instructions	10
Hard drive installation	11
Hard drive configuration	12
PCB/cable reference diagram	13
TFT contols / menu operation	14
TFT menu guide	15
Hidden contols / features	16
Card reader & I/O ports	17
Touch panel software installation	18



S21T specifications

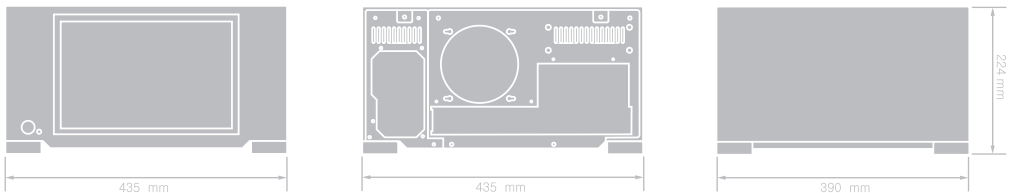

External dimensions (WxHxD)	435 x 224 x 390mm
Construction materials	all aluminium chassis
Motherboard support	ATX, micro ATX, mini-ITX
PSU support	ATX PSU
PCI card support	full size
Drive bays	10 x 3.5" internal drive bays 1 x 5.25" external drive bay
Fan support	1 x 120mm low dB exhaust fan 2 x 92mm low dB intake fans
Expansion slots	7
Front I/O ports	2 x USB 2.0 ports 1 x 1394 port 1 x headphone (HD & AC97) 1 x microphone (HD & AC97) 1 x multi format card reader
IR support	iMON IR controller (IR310)
Net weight	9.8kg
Available colours	black, silver
TFT specification	12.1" screen size (16:10) 1280 x 800 native resolution 1920 x 1080 max resolution 1 x SVGA input 12V dc input 9w power consumption

S21T overview

The following diagrams (below and overleaf) highlight the main features and controls of the S21T htpc enclosure. Further information can be found throughout this user guide.

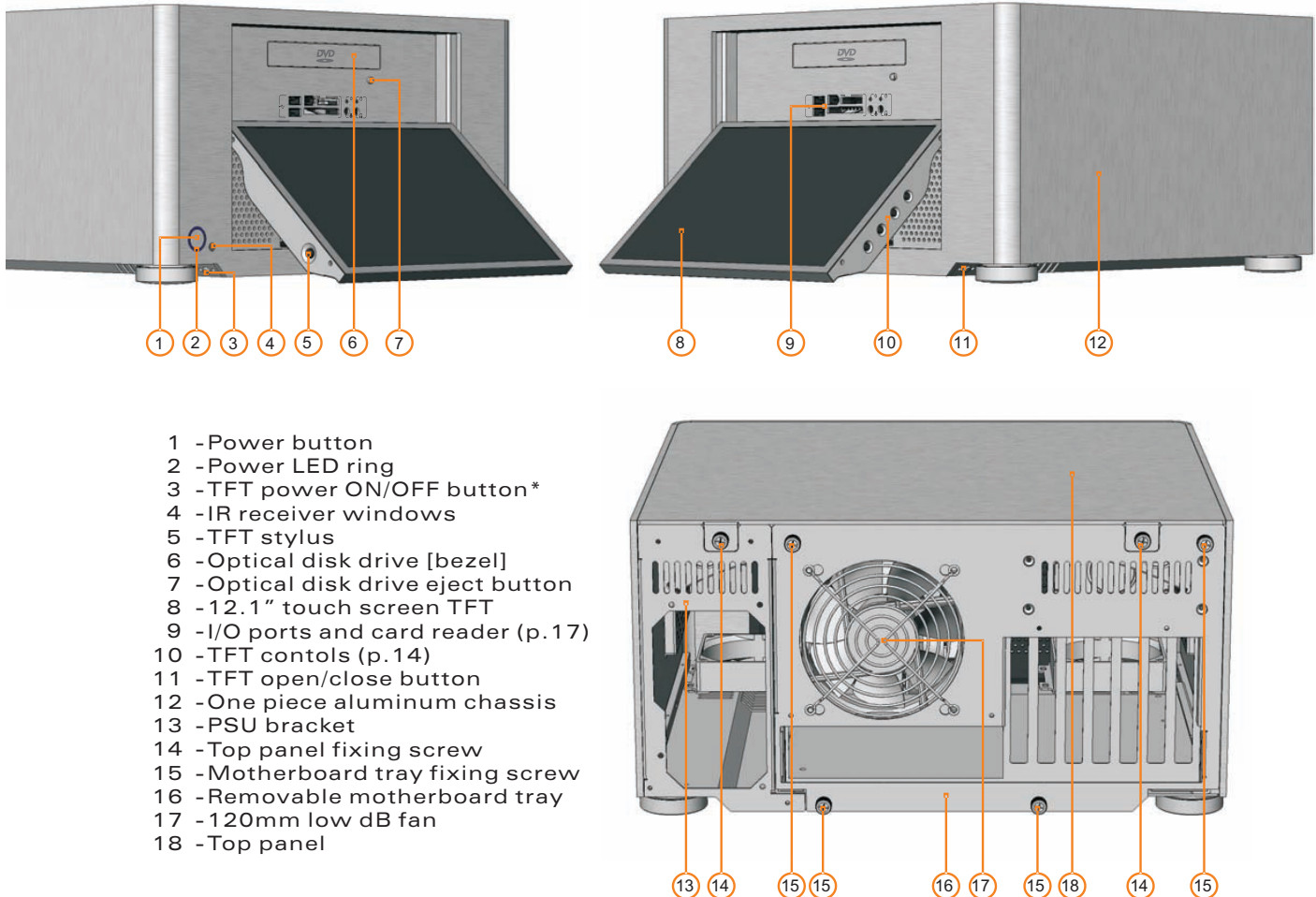

*see page 16 for auto-poweron feature

S21T overview

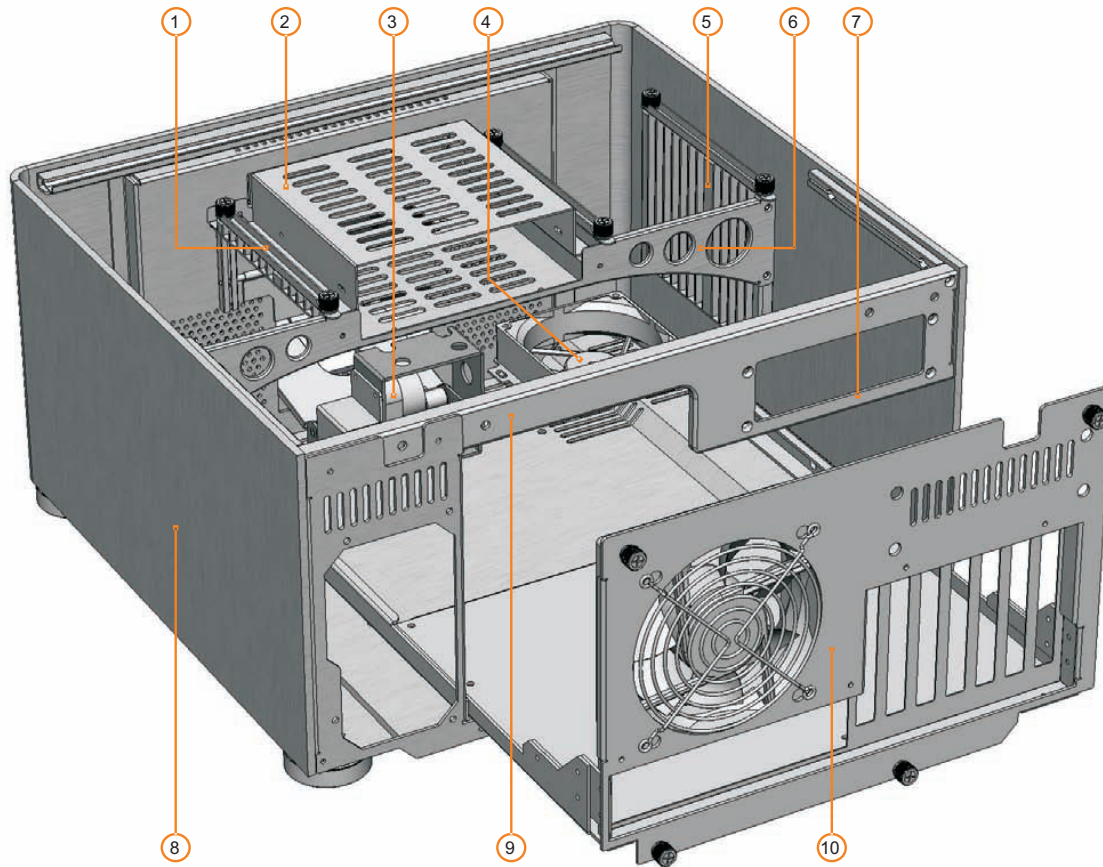

- 1 -Hard drive (HD) stop-rail
- 2 -Optical disk drive (ODD) cage
- 3 -Motor assembly
- 4 -92mm low dB fan
- 5 -HD mounting bracket
- 6 -ODD/HD support strut
- 7 -Extractor module mount
- 8 -One piece aluminum chassis
- 9 -Moulded back panel frame
- 10 -Removable motherboard tray

Opening the case / removing the motherboard tray

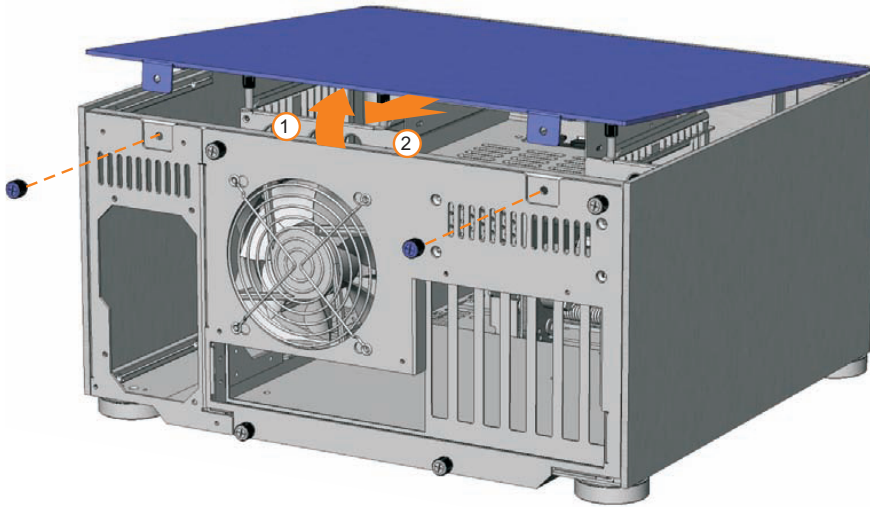

Opening the case

To remove the lid of the case, undo the 2 thumb screws as indicated. Carefully lift the lid from the back but not too far - DO NOT FORCE, and then pull backwards. Reverse procedure to replace lid.

Removing the motherboard tray.

Undo the 4 thumb screws as indicated below. Pull the tray backwards to remove. Reverse this procedure when replacing the tray, ensuring it is located in the tray guides correctly.

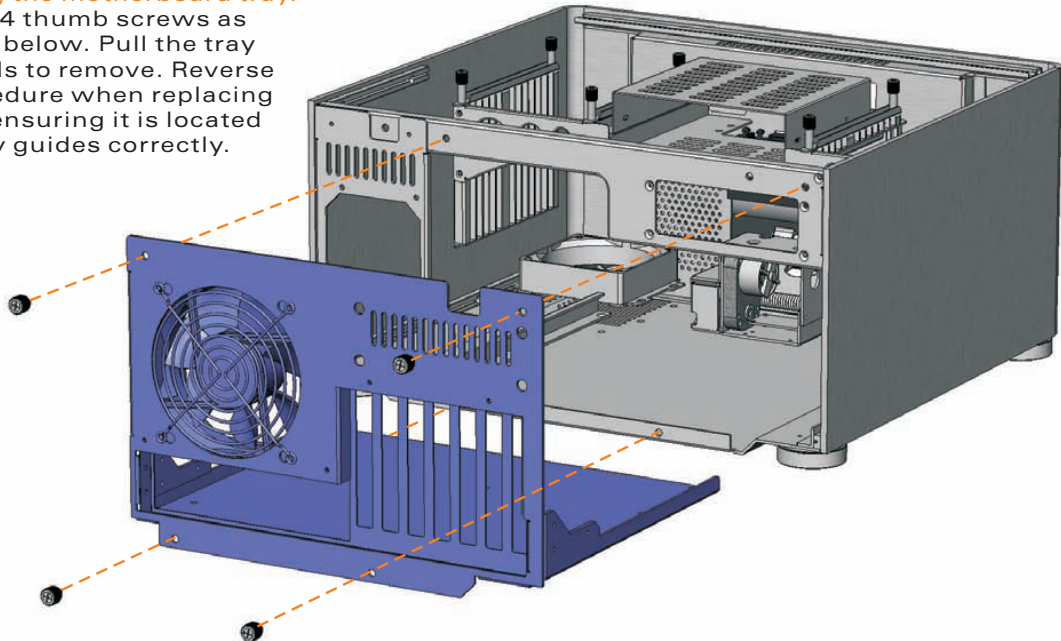

Micro ATX standoff / VGA loop cable installation

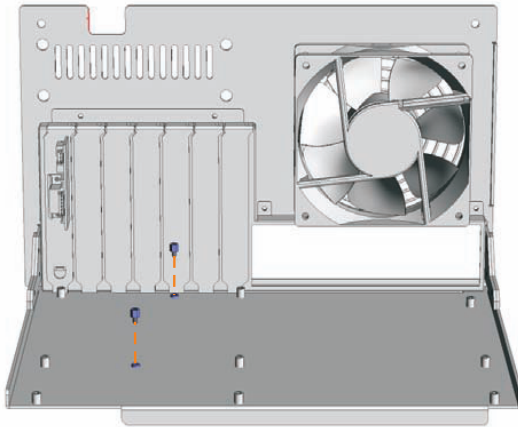

Micro ATX standoff installation

When installing a micro ATX motherboard, screw the 2 standoffs provided in the locations illustrated above. These are for micro ATX only and **MUST** NOT be installed if using a full ATX motherboard.

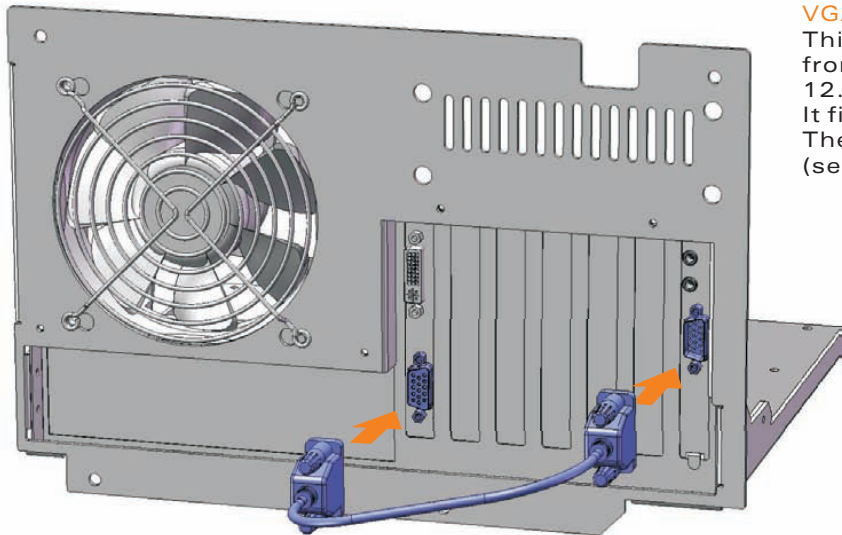

VGA loop cable

This cable loops the VGA signal from the graphics card to the 12.1" TFT via the VGA bracket. It fits to the connectors as shown. The VGA is then connected internally (see page 13 for PCB / cable reference).

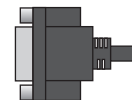

VGA input
(connector
hub PCB)

Optical disc drive (ODD) installation

Remove the ODD cage by undoing the 4 screws as illustrated below. Install ODD into the cage using the correct screws (supplied). Re-position the cage, with drive, and replace all screws to secure. Adjust (forward/back) position as necessary to ensure functionality of ODD eject button.

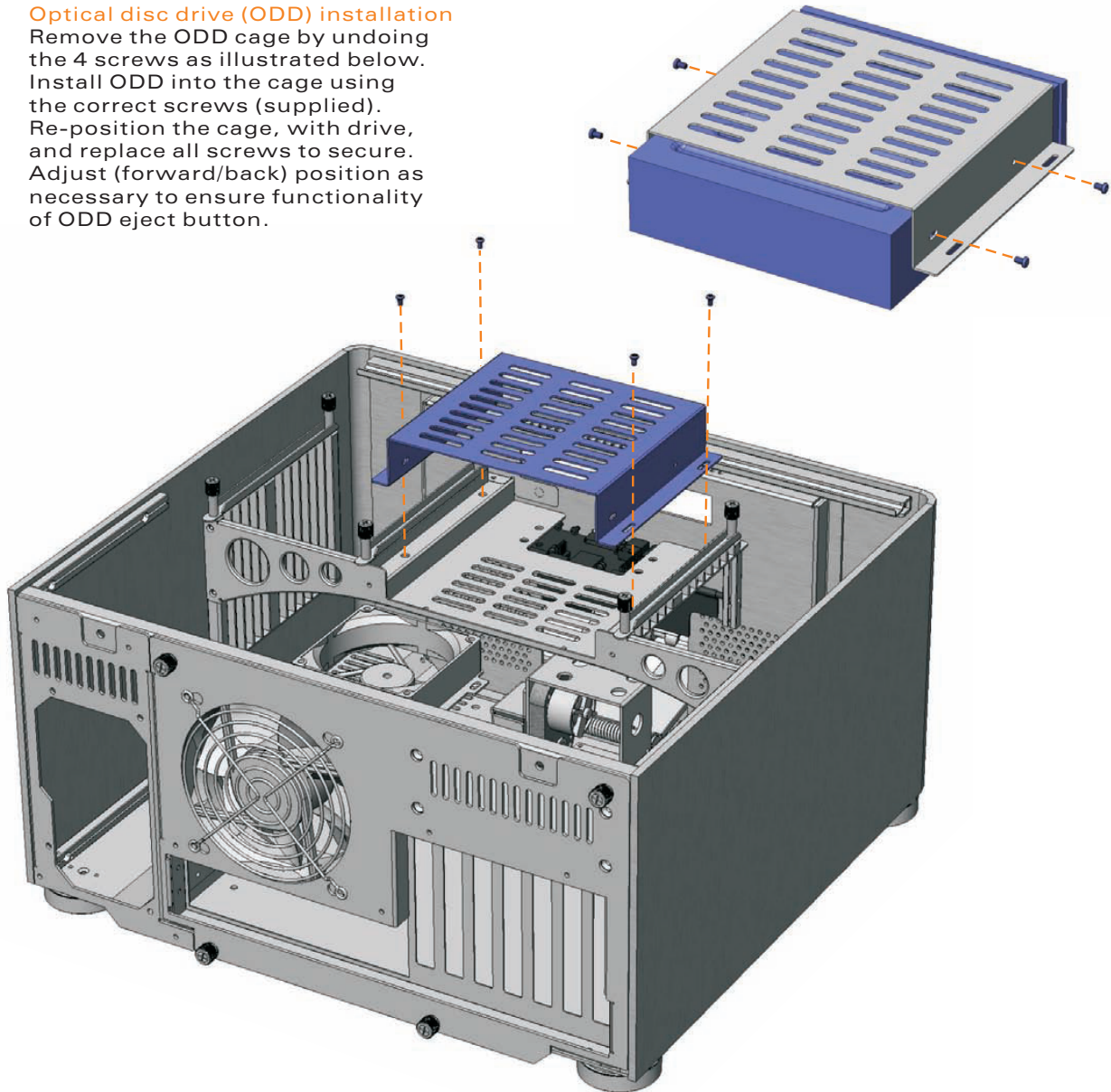

ODD bezel / metal sticker installation

Optical disk drive (ODD) bezel installation.

The aluminum ODD bezel matches the finish of the case. The installation procedure requires that the plastic drive bezel that comes fitted to your drive, be removed prior to installation. The drive format icon should also be fitted to the bezel before installation. The metal sticker sheet supplied has Blu-ray, HD-DVD or DVD icons, depending on the format being used.

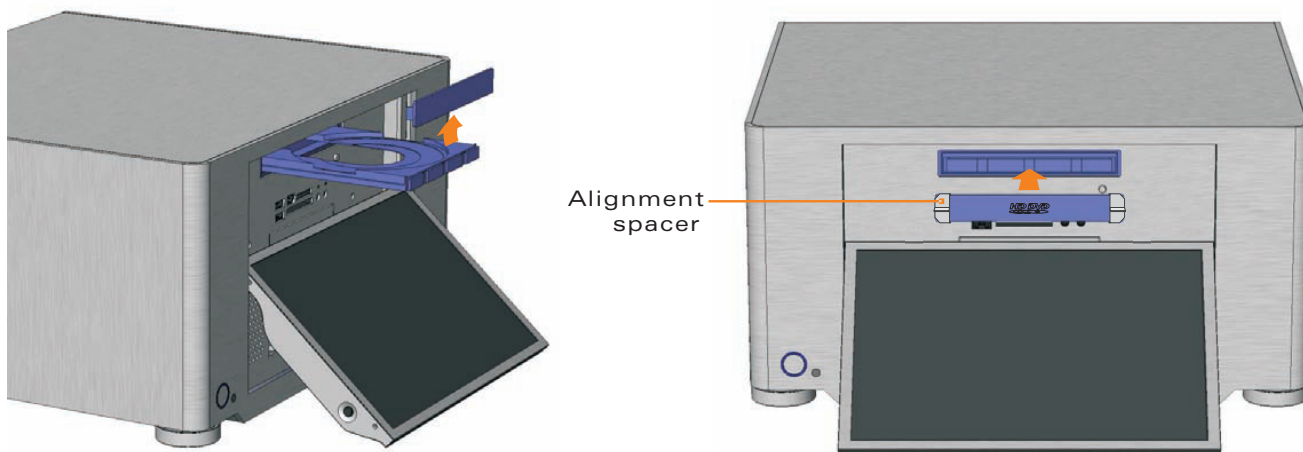

Remove the existing plastic drive bezel from your ODD. This is usually done by unclipping it and sliding it upwards. The disc tray should be ejected when doing this to gain access to the bezel.

With the tray closed, peel the back off the adhesive foam strip on the back of the bezel. Using the cardboard spacers, position the bezel as shown and press firmly to ensure good adhesion. Eject the tray to remove the spacers (a gentle tug may be required).

Metal sticker fitting instructions.

Ensure the bezel is free from dirt or grease. Peel and fold back the yellow backing sheet, revealing only the icon you intend to use. Carefully position the icon as central as possible, then apply even pressure over the entire area. Peel off the plastic film (and unused icons) to reveal your handy work!

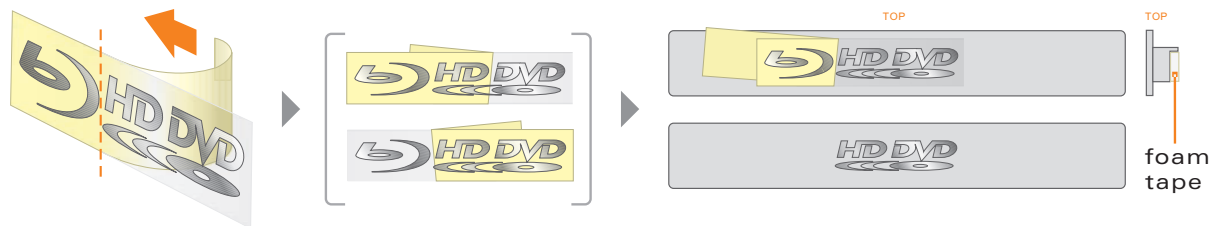

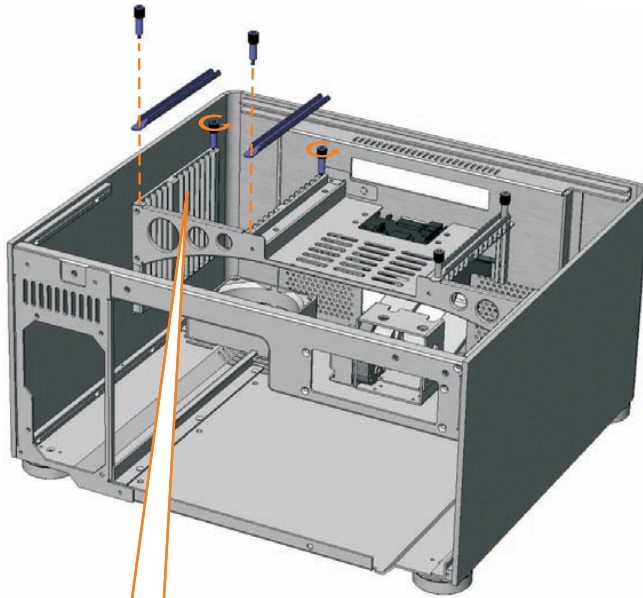

Hard drive installation.

To begin installation, remove the stop-rails as shown. You may need to loosen the screws first with a screwdriver. Drives must always be installed with the label facing toward the front of case. Screw three rubber mounting screws into the drive as shown below (the screw arrangement is mirrored for drives installed on the opposite side). Use the chart on page 12 to determine location, then lower the drive into place, carefully guiding the bottom rubber mount straight down the outer mount guide until the upper mounts are sitting snugly at the top of opposing guides. Once all drives have been installed, secure the stop-rails.

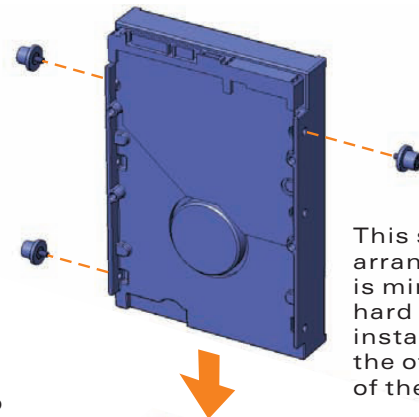

This screw arrangement is mirrored for hard drives installed on the other side of the case.

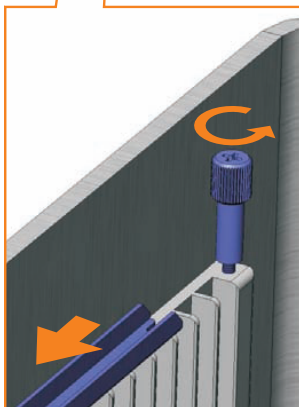

HD stop-rails.

When removing the stop-rails, only the back screw need be fully unscrewed—loosening the front thumb screw is all that's required to remove the stop-rail in the direction shown.

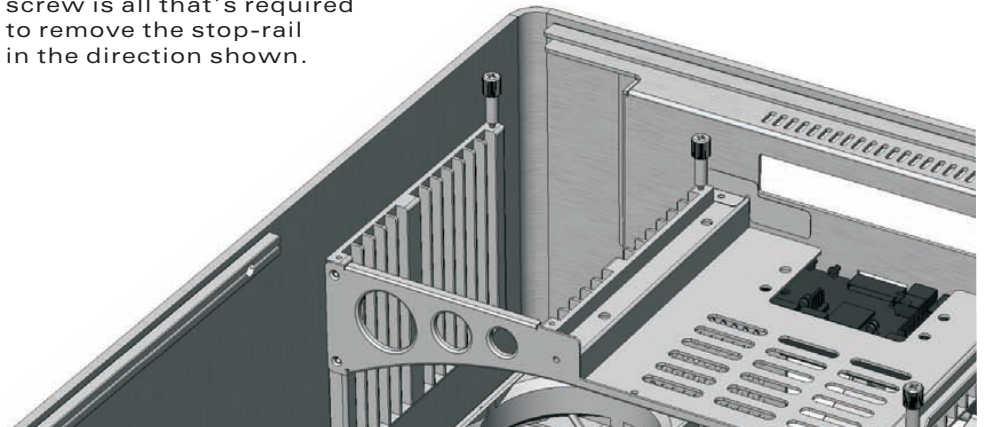

Hard drive configuration

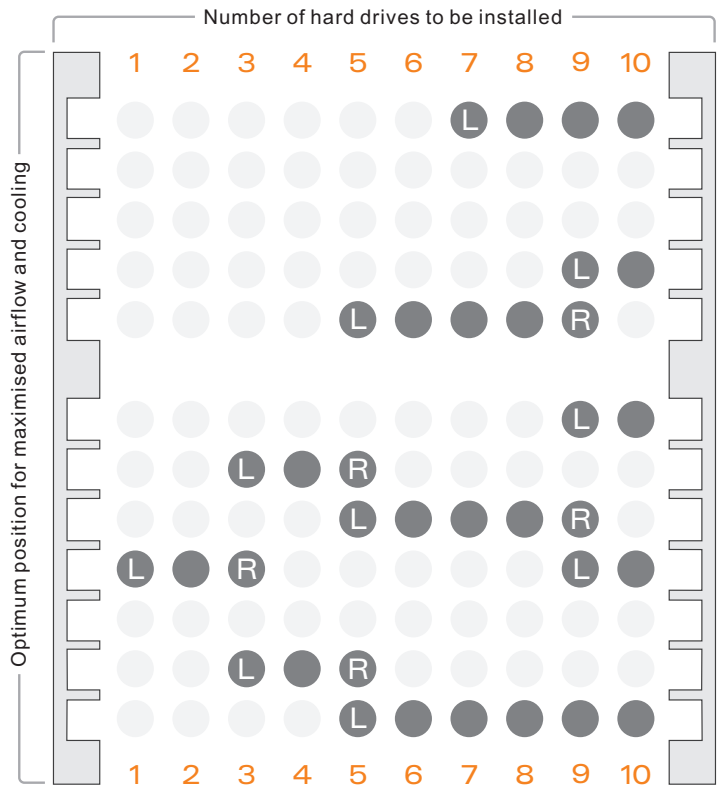

Hard drive configuration.

In order to maximise airflow and cooling of the hard drives, use the chart on the left to determine the optimum install configuration for the number of drives to be installed. When more than 6 drives are required, careful motherboard and PCI card selection is recommended, as in some cases M/B connector pin position or an oversized graphics card may inhibit some drive configurations. If this occurs, the drive positions can be reversed (left to right) or the drive spacing decreased as needed. Always try to maximise the airflow wherever possible.

- L drive on the left side only
- R drive on the right side only
- drive on both sides

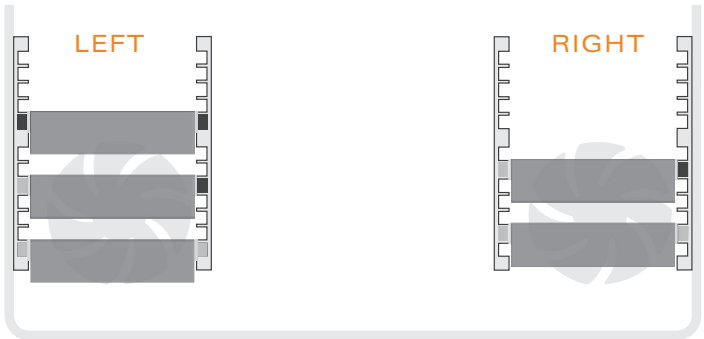

This diagram illustrates a five HD configuration using the chart above.

PCB/cable reference diagram.

This is a general overview illustrating how the S21T PCBs interconnect. PCBs / Cables dimmed in grey, come as part of an IR kit (sold separately). Please refer to your motherboard manual for the location of the correct ports and header pins.

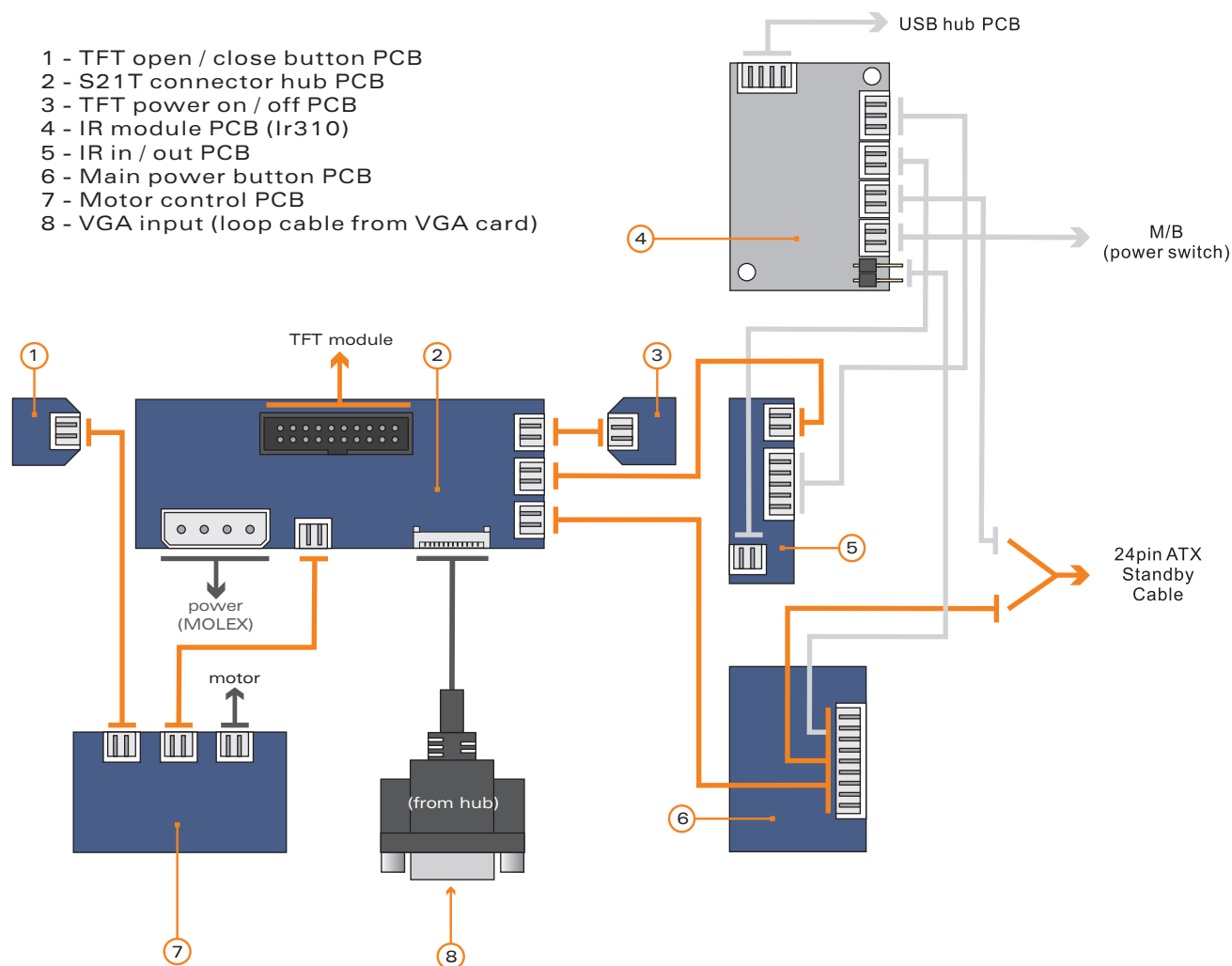

TFT controls / menu operation

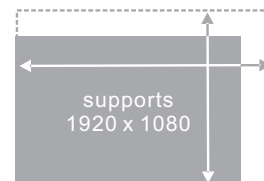
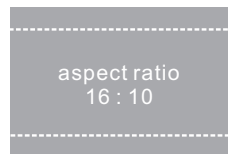

TFT controls / menu operation

Begin by pressing the (menu/set) button to bring up the on screen display (OSD). Use the and buttons to navigate through the 10 menu categories. Press the button to select a category, then (where appropriate) use to and to increase or decrease the value as desired. Press the button again to confirm the setting and repeat the process until you have made all the required adjustments. To exit the OSD, simply locate the EXIT category (10/10) and press (it will also exit automatically after approximately 10 seconds of inactivity). The menu guide on the next page shows the route and the adjustment sequence for each menu category (each assumes you are not already in the menu, with the exception of Exit).

TFT power on / off *

Menu / set

Value up

Value down

*see page 16 for auto - power on feature

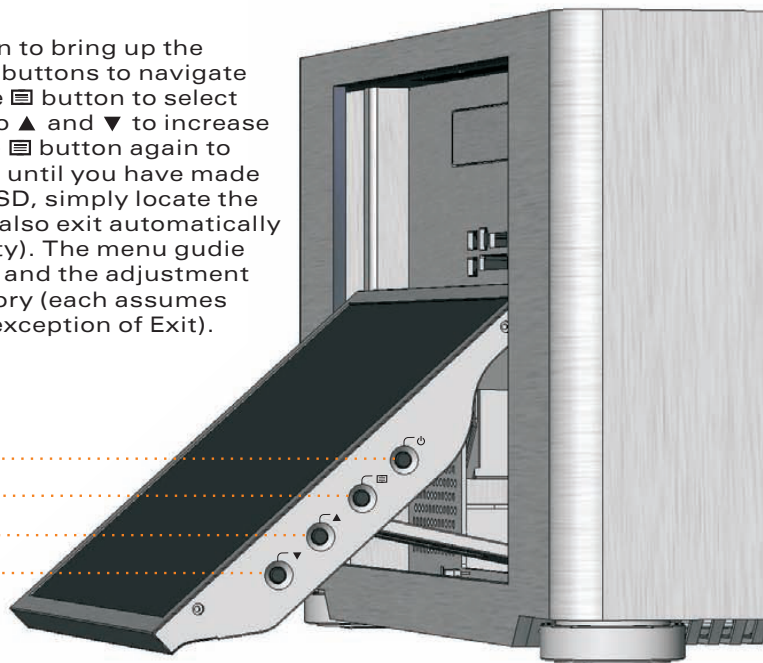

- 1 BRIGHTNESS - adjusts the picture brightness.
- 2 CONTRAST - adjusts the picture contrast.
- 3 PHASE - adjusts the noise of the image.
- 4 CLOCK - adjusts video sampling clock.
- 5 H POSITION - adjust the image horizontally.
- 6 V POSITION - adjust the image vertically.
- 7 LANGUAGE - language selection (default English).
- 8 AUTO - auto image adjust wizard.
- 9 RESET - resets to factory setting.
- 10 EXIT - exits the TFT menu.

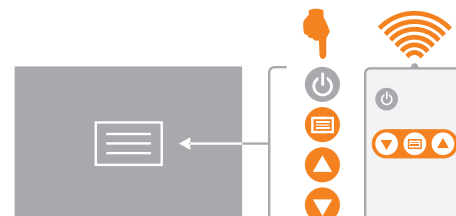

Brightness.

follow the steps below to adjust brightness.

**Contrast.**

follow the steps below to adjust contrast.

**Phase.**

follow the steps below to adjust phase.

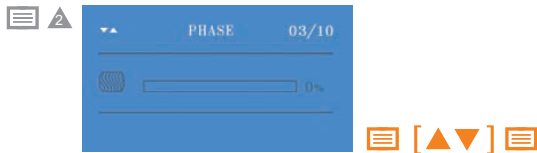
**Clock.**

follow the steps below to adjust clock speed.

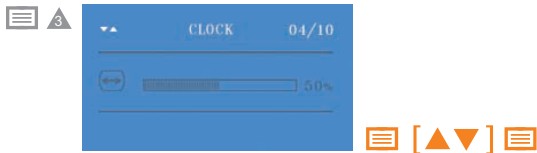
**H positions.**

follow the steps below to adjust H position.

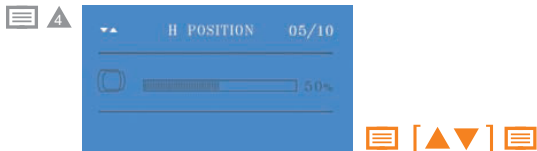
**V positions.**

follow the steps below to adjust V position.

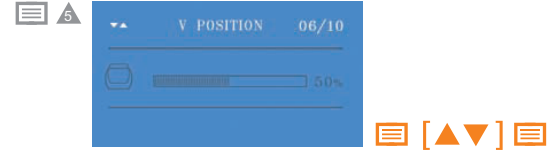
**Language (default is English).**

follow the steps below to change language.

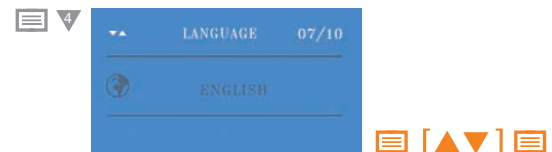
**Auto-adjust wizard.**

follow the steps below to auto-adjust image.

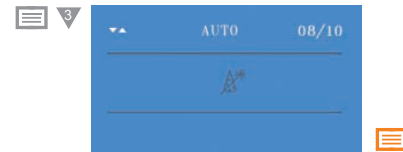
**Reset to factory settings.**

follow the steps below to reset settings.

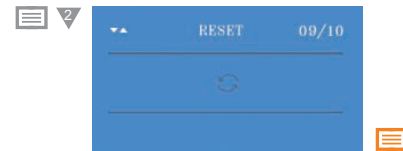
**Exit.**

follow the steps below to exit OSD.



Hidden controls / features

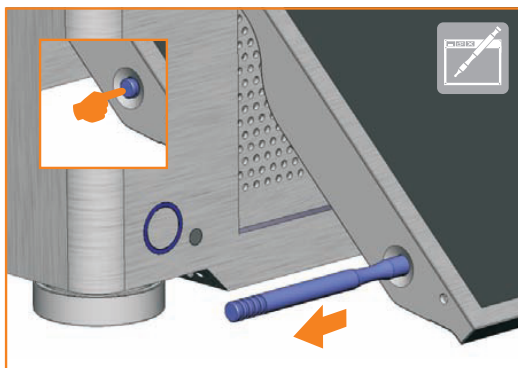



Hidden controls / features

A few of the S21T's controls and features have been discreetly located in order to retain the clean styling of the enclosure. These are as follows:

 **TFT power on/off** - Quick access button located near main power button with same functionality as the power button on the TFT

 **TFT stylus location** - Press to release lock, pull out to remove. Slide stylus into the opening (tip first) and press to lock and stow

 **Auto-power on feature** - Located on the back of the TFT, between the ▲ and ▼ button. Switched ON the TFT auto-powers up on boot, switched OFF the TFT remains off on boot.

 **TFT open/close** - Opens and closes the TFT panel, to provide access to the ODD drive, multi-format card reader and front I/O ports.

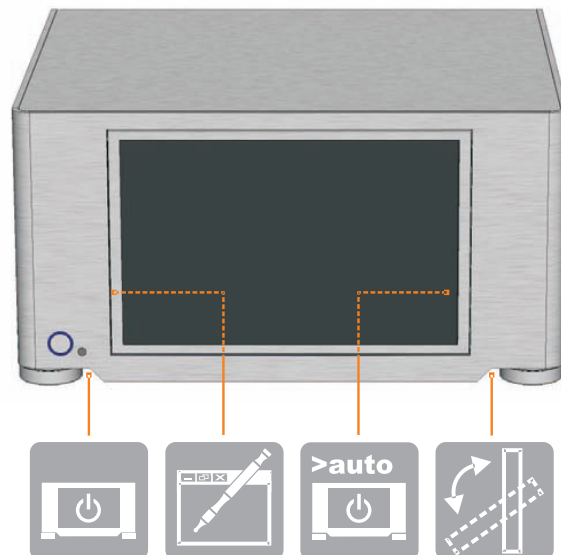



Multi-format card reader & I/O ports

Multi-format card reader & I/O ports

The S21T comes fitted with a multi-format card reader as well as front audio, USB and 1394 ports. The [internal] USB hub feeds the 2 front USB ports as well as the IR control and TFT touch panel, freeing up USB connectors on the motherboard. The front audio ports support both AC97 and HD audio standards, while the card reader supports all the card formats.

- 1 - USB port
- 2 - 1394 port
- 3 - Compact flash reader
- 4 - Multi format reader
- 5 - Card reader power LED
- 6 - Activity indicator LED
- 7 - Audio socket
- 8 - Audio socket

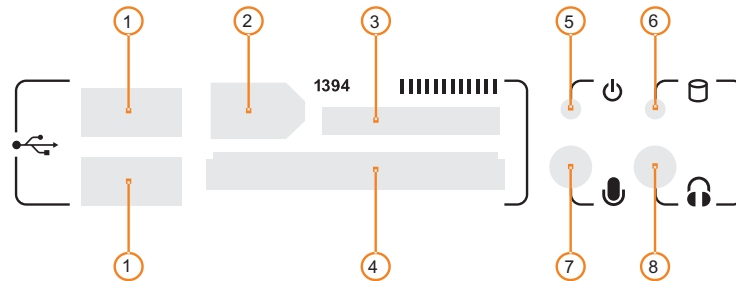

- | | | |
|-----------------------------------------|-----------------------------------------------|------------------------------------------------------------------------------------------------|
| 1 Compact Flash Card TYPE I | 20 Secure Digital Ultra II Plus Card | 39 Memory Stick (Magic Gate / High Speed data transfer compatible) |
| 2 Compact Flash Card TYPE II | 21 Secure Digital Card 45X | 40 Memory Stick (Magic Gate / High Speed data transfer compatible with memory select function) |
| 3 Compact Flash Ultra Card TYPE I 45 X | 22 Secure Digital PRO Card 66X | 41 Memory Stick Pro |
| 4 Compact Flash Ultra Card TYPE I 80 X | 23 Secure Digital Card 80X | 42 Magic Gate Memory Stick |
| 5 Compact Flash Ultra Card TYPE I 120 X | 24 Secure Digital Card 133X | 43 Magic Gate Memory Stick |
| 6 Compact Flash Ultra II Card TYPE I | 25 Secure Digital Card 150X | 44 Memory Stick Pro HS |
| 7 Compact Flash Extreme Card | 26 Mini Secure Digital Card | 45 Memory Stick Pro Ultra II |
| 8 Compact Flash Extreme III Card | 27 Mini Secure Digital Ultra II Card | 46 Memory Stick Pro Extreme |
| 9 Compact Flash ELITE PRO Card | 28 Mini Secure Digital Card 80X | 47 Memory Stick Pro Extreme III |
| 10 Compact Flash Ultimate Card 100X | 29 Mini Secure Digital PRO Card | 48 Memory Stick Pro |
| 11 Compact Flash Ultra-X Card 140X | 30 Micro Secure Digital Card | 49 Memory Stick Pro Duo |
| 12 IBM Micro Drive Card | 31 Micro Secure Digital Ultra II Card | 50 Memory Stick Pro Duo HS |
| 13 Sony Micro Drive Card | | 51 Memory Stick Pro Duo |
| | | 52 Memory Stick Duo (Magic Gate / High Speed data transfer compatible) |
| 14 Smart Media Card | 32 Multi Media Card | 53 Memory Stick Pro Duo |
| | 33 Multi Media PRO Card | 54 Magic Gate Memory Stick Duo |
| 15 XD-Picture Card | 34 Multi Media Plus Card | 55 Magic Gate Memory Stick Duo |
| | 35 Reduced Sized Multi Media Card | 56 Memory Stick ROM |
| 16 Secure Digital Card | 36 Reduced Sized Multi Media Mobile Card | |
| 17 Secure Digital Ultra II Card | | |
| 18 Secure Digital Extreme Card | 37 Memory Stick | |
| 19 Secure Digital Extreme III Card | 38 Memory Stick (With memory select function) | |

NOTE: Card adapter required for some formats

Touch panel software installation



Touch panel software installation.

In order to use the touch panel, you must first install the TouchKit software from our website. To start the software installation, double click on the setup.exe file located in the TouchKit folder.

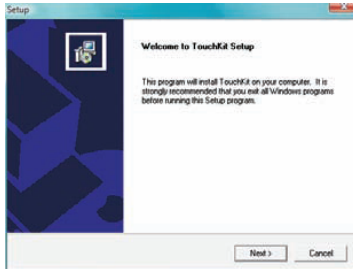

1 After opening the setup.exe file, the install will begin with the above prompt. Click 'Next' to continue.

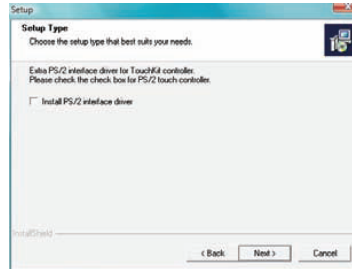

2 Ensure that 'install PS/2 interface driver' is not selected and click 'Next'.

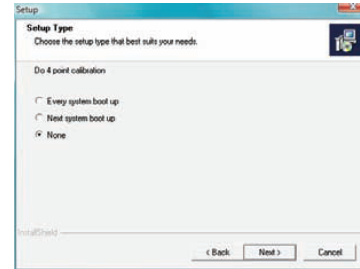

3 Select 'None' and click 'Next'. After completing the install, the TouchKit software will perform a 4 point calibration.



4 The touchscreen controller should already be connected if you have correctly connected all cables inside your chassis. Click 'OK'.

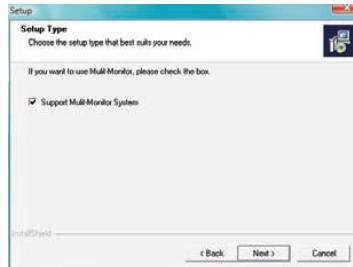

5 If you intend to use spanning mode with multiple monitors, please select 'Support Multi-Monitor Systems'. Click 'Next' to continue.

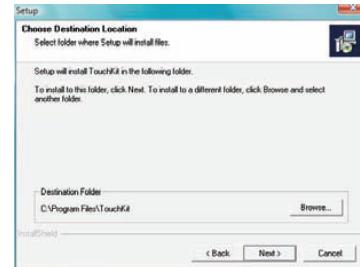

6 Change the TouchKit software install folder if required and click 'Next' to continue.

Touch panel software installation

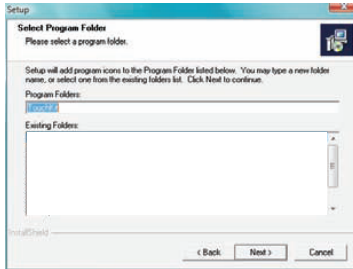

7 Change the Program Folder name if required and click 'Next' to continue.

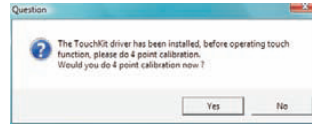

8 Click 'Yes' to perform a 4 point calibration. This is required for proper touch screen operation.

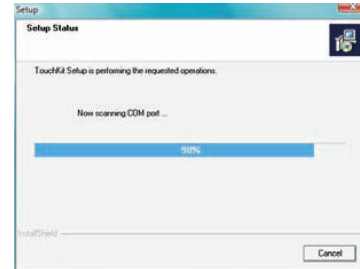

9 The software will now scan and install the touch screen device. The TouchKit calibration procedure will follow.

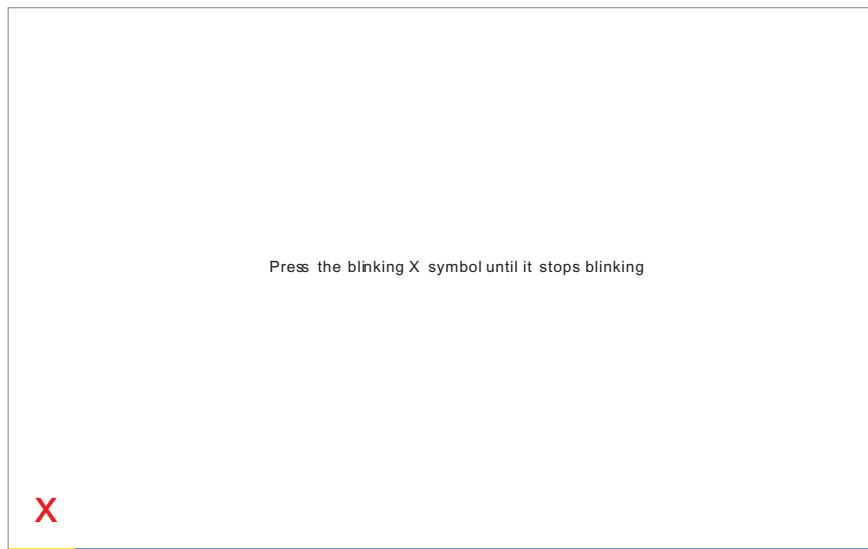

10 To perform the calibration, press and hold down the X that blinks in the corner of the screen, until it disappears. Repeat this procedure with each of the 4 X's that appear. On completion of this, the touch screen will be calibrated and ready for use.





Global HQ
#209 Baesan B/D
763-2 Hengsin-Dong
Dukyang-Gu
Goyang City
Gyeonggi-Do
412-220 South Korea

Website
www.origenæ.com